



DW5SNMP20
(CS121)



DW5SNMP30
(CS121)



DW7SNMP20
(CS121Budget)



DW7SNMP30
(CS121Budget)

Features

✓ High-Tech made in Germany: The most powerful and flexible UPS management card worldwide! 32-Bit RISC-Processors, 10/100Mbit auto-sensing Ethernet, 2 serial RS-232 Interfaces (not BUDGET version), AUX port for 4 dry-contact external alarms output/input (not Budget version), (optional) MODBUS RS 485 interface.	✓ Multiserver Shutdown: Unlimited shutdown manager for RCCMD clients – for more than 40 different operating systems. This makes it possible for a CS121 adapter to inform and shutdown any type of computer in a given network which can then be used to centralise the administration of large networks while greatly reducing both the amount of organisational work and the amount of consumed network time for communications. Different methods are available for conducting shutdowns and system start ups: 1. Coldboot (Computers are directly cut-off from or connected to the power supply. This option may require a SiteSwitch.) 2. Warmboot (Using RCCMD operating systems are prompted to shutdown or restart.) 3. Wake on LAN (Using data packages other computers in a local network are prompted to start-up.)
✓ Graphical and non-graphical interfaces: Several options are available for monitoring and configuring the adapter both visual: Windows UPSMON, JAVAMON, UNMS, every type of SNMP network management station, internet browsers and non-visual: TELNET, FTP. Additionally supported is the GENEREX API. The statistical analysis is graphically shown through the GCHART plugin for the Microsoft Internet Explorer. Those statistics show the values of the UPS and all connected external devices like temperature, humidity, etc.	✓ Network Services: UPSMAN compatible software for Alarm management. Supports SNMP, HTTP, Telnet, ARP, TCP, UDP, DNS, SMTP, NTP, FTP, UPSTCP (UPSMON, UNMS), PPP, RCCMD, RCCMD2 (Multiserver/Multi-OS shutdown/messaging tool) Standard basis for parallel redundant UPS with USW (UPS SNMP WATCH) and the new GENEREX UNMS 2 networkmanagement system.
✓ Suitable for every type and make of UPS: Supports more than 1400 UPS types from 60 UPS manufacturers. The incorporation of RS232 protocol and support of dry contacts makes the monitoring of virtually any device possible.	✓ MODEM: Support for ISDN, analogue and GSM Modems for the remote monitoring and administration of UPS and other connected Genex devices. The function makes administration of the UPS system possible without compromising the security of the network it is servicing. (not budget version)
✓ Log book: Measurement values and alarms are written with time stamps into the non-volatile storage of the CS121 adapter. The time synchronisation function insures that all protocols are written with precise time values.	✓ SNMP / HP Openview: Includes free Snap-In for HP Openview for Windows. The CS121 supports the RFC1628 MIB (Standard UPS MIB) and MIB extensions for use with the SITEMANAGER, SITESWITCH 4, and SENSOR MANAGER. This enables the CS121 adapter to make all of its gathered information from other devices available via SNMP and this has been tested with Sun Netmanager, IBM Netview, Tivoli, Unicenter, Cabletron Spectrum, Managewise, and Castlerock and many other SNMP based networkmanagement systems. Additionally Ipswitch WHATS UP 6 and HP/COMPAQ Insightmanager is supported.
✓ Graphical operation and statistics: The CS121 WEB-Server provides its users with a simple to use overview for a broad range of functionality within its monitoring and configuration capabilities. The CS121 adapter also has the highest performing graphical analysis tool in its class for dynamic data evaluation.	✓ BACS Batteriemanagementsystem / MODBUS over IP: The CS121 can also monitor the battery management system BACS which protects UPS customers from unexpected battery failures. All of the CS121 adapters are equipped with MODBUS over IP which enables the CS121 to also incorporate PLC devices like those from the Schneider Group. (not budget version)
✓ Email/SMS: Integrated Email client via SMTP can be configured to relay either all or select UPS messages. The Email client can also make use of network messaging options for distributing information or use network internal email facilities. Compatible with SMTP email systems such as MS Exchange, Lotus, and many others.	✓ Scheduler: Webserver based Scheduler allows scheduled on/off of the UPS output or SITESWITCH receptables or to start batterytests. This secures that the UPS runs regularly batterytests and informs the user about problems via Email, logfile etc.

Function overview

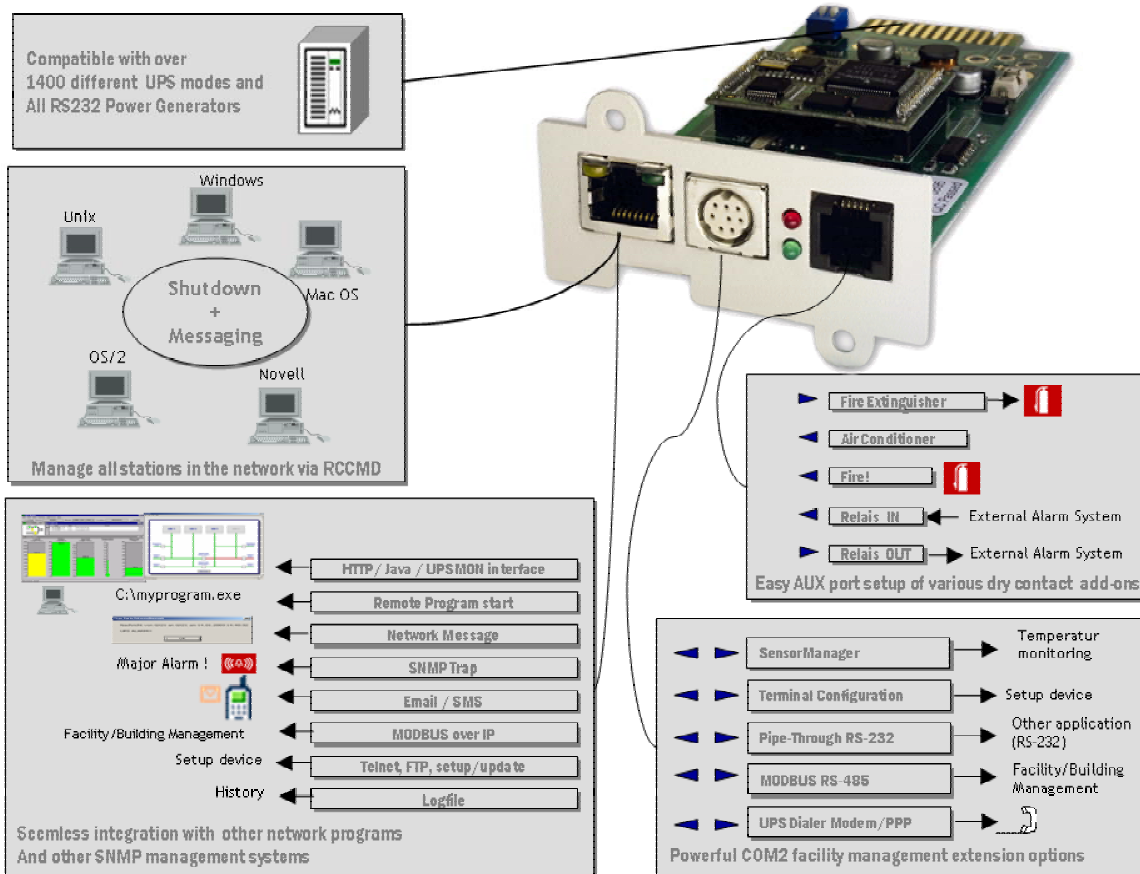

Picture: Function Overview of the CS121. The “BUDGET” is an economic version of CS121 has no COM2 (sensors, modbus, modem, Pipe-Thru, Terminalconfiguration) and AUX (dry contact interface). Beside this the BUDGET is identical to the full-qualified CS121.

Technical Data

	CS121 External	CS121 Slot (all vendors)
Power supply	12V (min. 9V, max. 36V DC), 350 mA	8-36V DC, 150 mA
Size, weight	69x126 mm, 210 g	60x120 mm, 66 g
Ethernet	10/ 100Mbit Base-T auto sense	10/ 100Mbit Base-T auto sense
RS-232 interface	2 (BUDGET : 1)	2 (BUDGET : 1)
RS-485 interface	Optional (not BUDGET)	Optional (not BUDGET)
MODBUS over IP	Standard for CS121, Optional : BUDGET	Standard for CS121, Optional : BUDGET
Status LED's	Normal green, boot/error red	Normal green, boot/error red
User manual	German, English	German, English
MIB	RFC 1628 and private extension	RFC 1628 and private extension
Operating temperature/ Humidity	0 – 40 °C 10-80%, not condensated	0 – 60 °C 10-80%, not condensated
Certifications	CE, UL	CE, UL
Warranty	2 Jahre	2 Jahre
Country of Origin	Germany	Germany